

400257 INSTALLATION INSTRUCTIONS

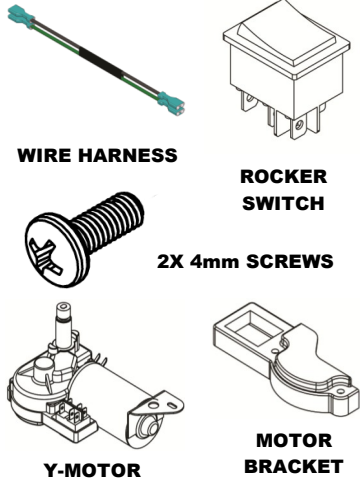

1 INSURE RECEIPT OF NECESSARY PARTS



2 INSTALL BRACKET AS SHOWN

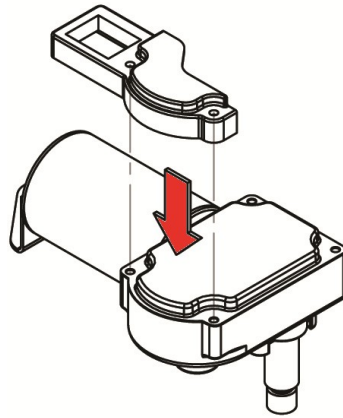

USE 4mm SCREWS TO SECURE BRACKET

3 INSTALL SWITCH AS SHOWN

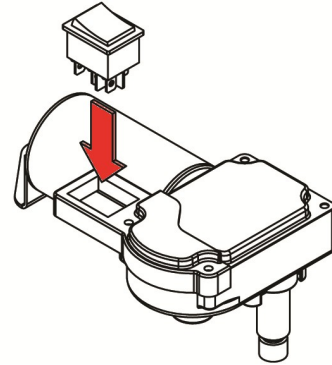

SWITCH SNAPS INTO PLACE

4 WIRE ROCKER SWITCH AS SHOWN

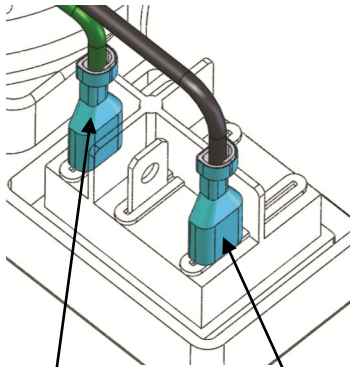

5 WIRE MOTOR TERMINALS AS SHOWN

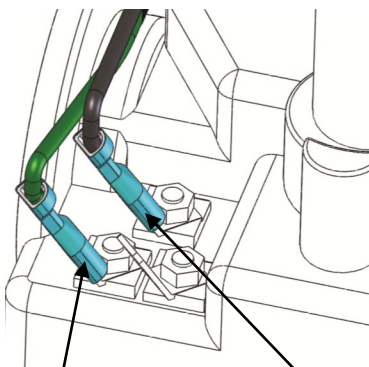

6 CONNECT SWITCH TO B+

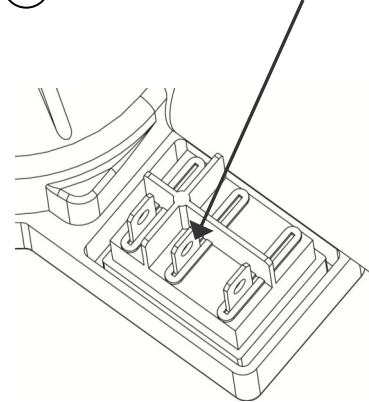

GROUND MOTOR HOUSING TO VEHICLE CHASSIS

7 TO USE THE FASTER OF THE TWO AVAILABLE SPEEDS, WIRE AS SHOWN

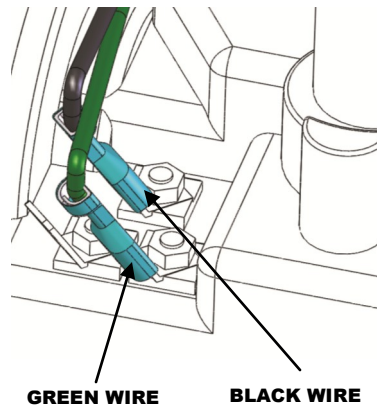

INCORRECT

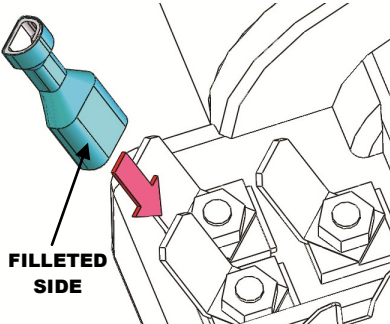

CORRECT

